

DETAIL A

MATERIALS & FEATURES

- 1.9" O.D. ASTM A53 steel tubing
- 6" radius bends (center to center)

FINISH

- Galvanized
 Galvanized to ASTM A123/A123M-12

MOUNTING OPTIONS

- Surface mount - Concrete (**Anchors Sold Separately**)

SPACE USE RECOMMENDATIONS

- Wall Setbacks:
 For racks parallel to a wall
 Suggested minimum clearance: 24"
- For racks perpendicular to a wall
 Suggested minimum clearance: 36"
- Distance between racks
 Suggested minimum clearance: 24"

*These are our suggested minimal clearances.

**Please check local ordinances for minimum clearance

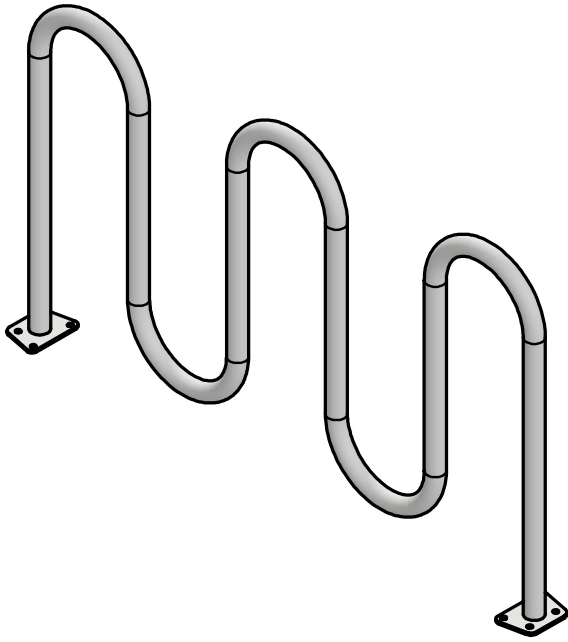

MATERIALS & FEATURES

- 1.9" O.D. ASTM A53 steel tubing
- 6" radius bends (center to center)

FINISH

- Galvanized
 Galvanized to ASTM A123/A123M-12

MOUNTING OPTIONS

- Surface mount - Concrete (**Anchors Sold Separately**)

SPACE USE RECOMMENDATIONS

- Wall Setbacks:
 For racks parallel to a wall
 Suggested minimum clearance: 24"
- For racks perpendicular to a wall
 Suggested minimum clearance: 36"
- Distance between racks
 Suggested minimum clearance: 24"

*These are our suggested minimal clearances.

**Please check local ordinances for minimum clearance

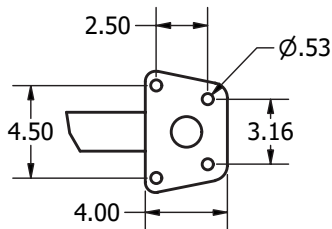
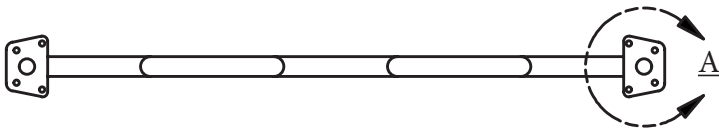
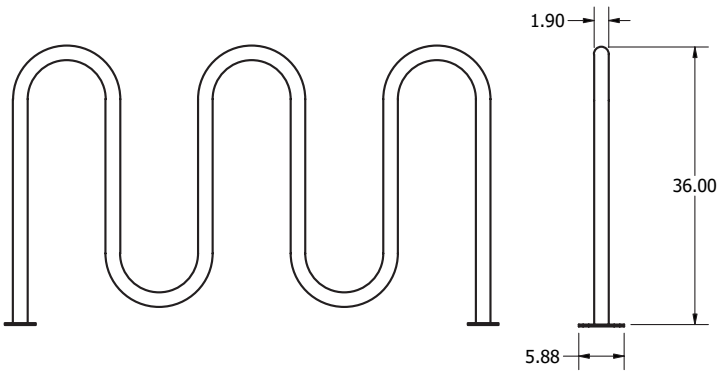

DETAIL A